

Massachusetts Department of Environmental Protection
Bureau of Resource Protection - Wetlands

Reading
City/Town

WPA Form 1- Request for Determination of Applicability

Massachusetts Wetlands Protection Act M.G.L. c. 131, §40 & READING
WETLAND PROTECTION BYLAWS SECTION 7.1

A. General Information

Important:
When filling out forms on the computer, use only the tab key to move your cursor - do not use the return key.

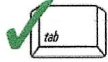

1. Applicant:

Name Capitol Construction E-Mail Address capitolconstruction.rmd@gmail.com
Mailing Address POB 962 Saugus
City/Town Saugus State MA Zip Code 01906
Phone Number 978 876 5488 Fax Number (if applicable)

2. Representative (if any):

Firm _____
Contact Name _____ E-Mail Address _____
Mailing Address _____
City/Town _____ State _____ Zip Code _____
Phone Number _____ Fax Number (if applicable) _____

B. Determinations

1. I request the Reading Conservation Commission make the following determination(s). Check any that apply:

- a. whether the **area** depicted on plan(s) and/or map(s) referenced below is an area subject to jurisdiction of the Wetlands Protection Act.
- b. whether the **boundaries** of resource area(s) depicted on plan(s) and/or map(s) referenced below are accurately delineated.
- c. whether the **work** depicted on plan(s) referenced below is subject to the Wetlands Protection Act.
- d. whether the area and/or work depicted on plan(s) referenced below is subject to the jurisdiction of any **municipal wetlands ordinance or bylaw** of:

Name of Municipality _____

- e. whether the following **scope of alternatives** is adequate for work in the Riverfront Area as depicted on referenced plan(s).

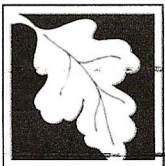

Massachusetts Department of Environmental Protection
Bureau of Resource Protection - Wetlands

Reading
City/Town

WPA Form 1- Request for Determination of Applicability

Massachusetts Wetlands Protection Act M.G.L. c. 131, §40 & READING
WETLAND PROTECTION BYLAWS SECTION 7.1

C. Project Description

1. a. Project Location (use maps and plans to identify the location of the area subject to this request):

167 Belmont St

Street Address

Reading 01867

City/Town

MAP 28

Assessors Map/Plat Number

Lot 97

Parcel/Lot Number

b. Area Description (use additional paper, if necessary):

on existing lawn

c. Plan and/or Map Reference(s):

LOCUS MAP

Title

10/30/22

Date

Title

Date

Title

Date

2. a. Work Description (use additional paper and/or provide plan(s) of work, if necessary):

Tear down old deck and build a

new one with same 10x6 measurements.
Deck builded in 2x8 PT using tie
Simpson hangers 2x8.

Vinyl railings 3ft height.

Deck floor builded in composite material.



Massachusetts Department of Environmental Protection
Bureau of Resource Protection - Wetlands

Reading
City/Town

WPA Form 1 - Request for Determination of Applicability

Massachusetts Wetlands Protection Act M.G.L. c. 131, §40 & READING
WETLAND PROTECTION BYLAWS SECTION 7.1

C. Project Description (cont.)

b. Identify provisions of the Wetlands Protection Act or regulations which may exempt the applicant from having to file a Notice of Intent for all or part of the described work (use additional paper, if necessary).

3. a. If this application is a Request for Determination of Scope of Alternatives for work in the Riverfront Area, indicate the one classification below that best describes the project.

- Single family house on a lot recorded on or before 8/1/96
- Single family house on a lot recorded after 8/1/96
- Expansion of an existing structure on a lot recorded after 8/1/96
- Project, other than a single-family house or public project, where the applicant owned the lot before 8/7/96
- New agriculture or aquaculture project
- Public project where funds were appropriated prior to 8/7/96
- Project on a lot shown on an approved, definitive subdivision plan where there is a recorded deed restriction limiting total alteration of the Riverfront Area for the entire subdivision
- Residential subdivision; institutional, industrial, or commercial project
- Municipal project
- District, county, state, or federal government project
- Project required to evaluate off-site alternatives in more than one municipality in an Environmental Impact Report under MEPA or in an alternatives analysis pursuant to an application for a 404 permit from the U.S. Army Corps of Engineers or 401 Water Quality Certification from the Department of Environmental Protection.

b. Provide evidence (e.g., record of date subdivision lot was recorded) supporting the classification above (use additional paper and/or attach appropriate documents, if necessary.)

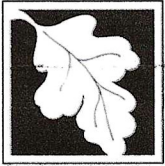

Massachusetts Department of Environmental Protection
Bureau of Resource Protection - Wetlands

Reading
City/Town

WPA Form 1- Request for Determination of Applicability

Massachusetts Wetlands Protection Act M.G.L. c. 131, §40 & READING
WETLAND PROTECTION BYLAWS SECTION 7.1

D. Signatures and Submittal Requirements

I hereby certify under the penalties of perjury that the foregoing Request for Determination of Applicability and accompanying plans, documents, and supporting data are true and complete to the best of my knowledge.

I further certify that the property owner, if different from the applicant, and the appropriate DEP Regional Office were sent a complete copy of this Request (including all appropriate documentation) simultaneously with the submittal of this Request to the Conservation Commission.

Failure by the applicant to send copies in a timely manner may result in dismissal of the Request for Determination of Applicability.

Name and address of the property owner:

Matthew Simpson
Name

136 Andorer St Wilmington MA 01887
Mailing Address

Wilmington
City/Town

MA
State

01887
Zip Code

Signatures:

I also understand that notification of this Request will be placed in a local newspaper at my expense in accordance with Section 10.05(3)(b)(1) of the Wetlands Protection Act regulations.

[Signature]
Signature of Applicant

11/26/2022
Date

[Signature]
Signature of Representative (if any)

11/28/2022
Date

Town of Reading Locus Map

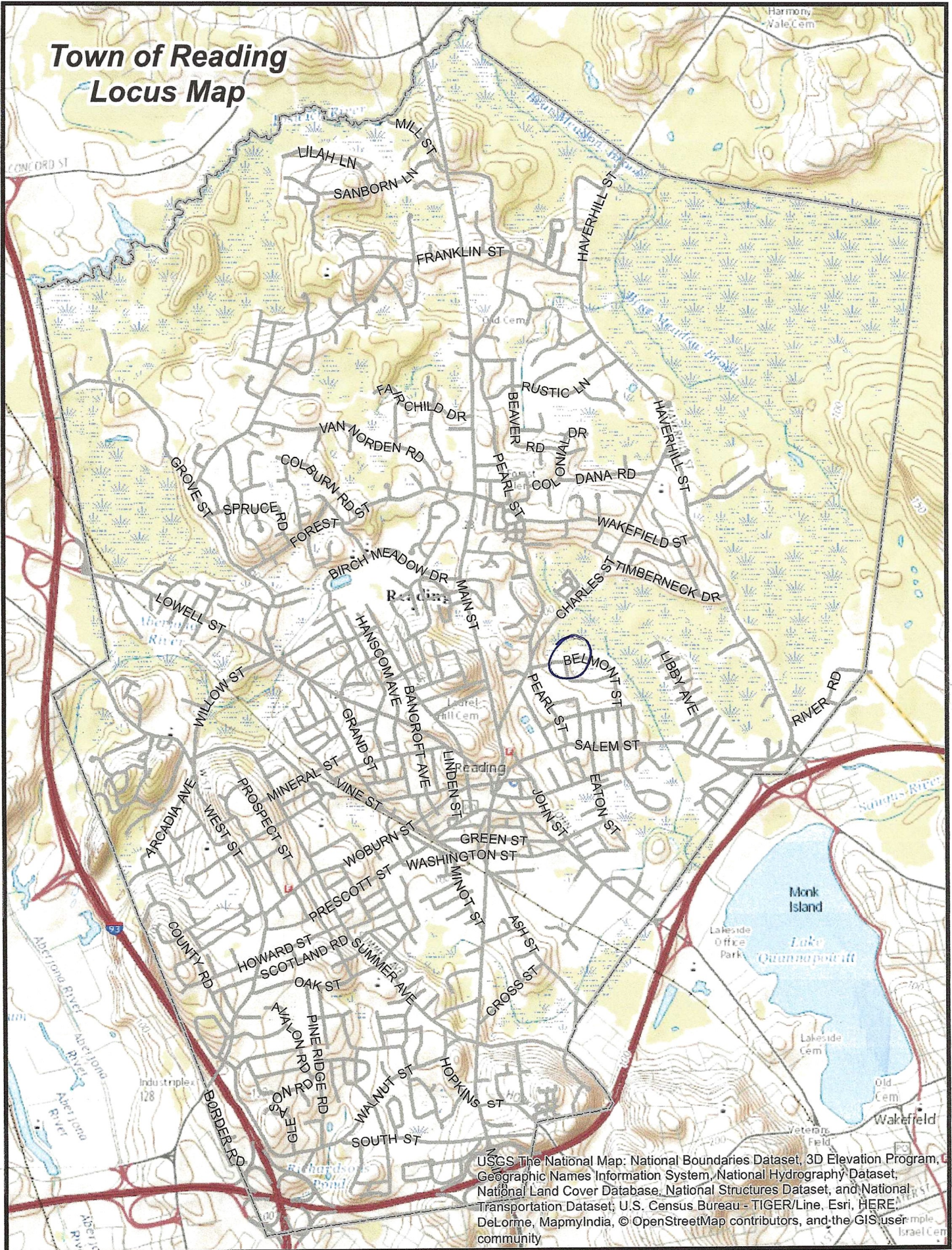

USGS The National Map: National Boundaries Dataset, 3D Elevation Program, Geographic Names Information System, National Hydrography Dataset, National Land Cover Database, National Structures Dataset, and National Transportation Dataset; U.S. Census Bureau - TIGER/Line, Esri, HERE, DeLorme, MapmyIndia, © OpenStreetMap contributors, and the GIS user community

AFFIDAVIT OF SERVICE

Under the Massachusetts Wetlands Protection Act, M.G.L., c.131, s.40 and Reading General Bylaws, Section 7.1

(To be submitted to the Conservation Commission when filing a Notice of Intent or Abbreviated Notice of Resource Area Delineation or Request for Determination of Applicability)

I, Capitol Construction (Name), hereby certify under the pains and penalties of perjury that on 10/30/2022 (Date), I gave notification to abutters in compliance with the second paragraph of Massachusetts General Laws, c.131, s.40, and the **DEP Guide to Abutter Notification** dated April 8, 1994, and Reading General Bylaws, Section 7.1 in connection with the following matter:

(Check the applicable form.)

- Notice of Intent
- Abbreviated Notice of Resource Area Delineation
- Request for Determination of Applicability

~~filed under M.G.L., c.131, s.40 and R.G.B., s.7.1 by~~
_____ (Applicant) with the Town of Reading
Conservation Commission on _____ (Date) for
property located at _____ (Location).

The form of the notification and list of abutters to whom it was given and their addresses are attached to this Affidavit of Service.

Capitol Const.
Name

11/26/2022
Date

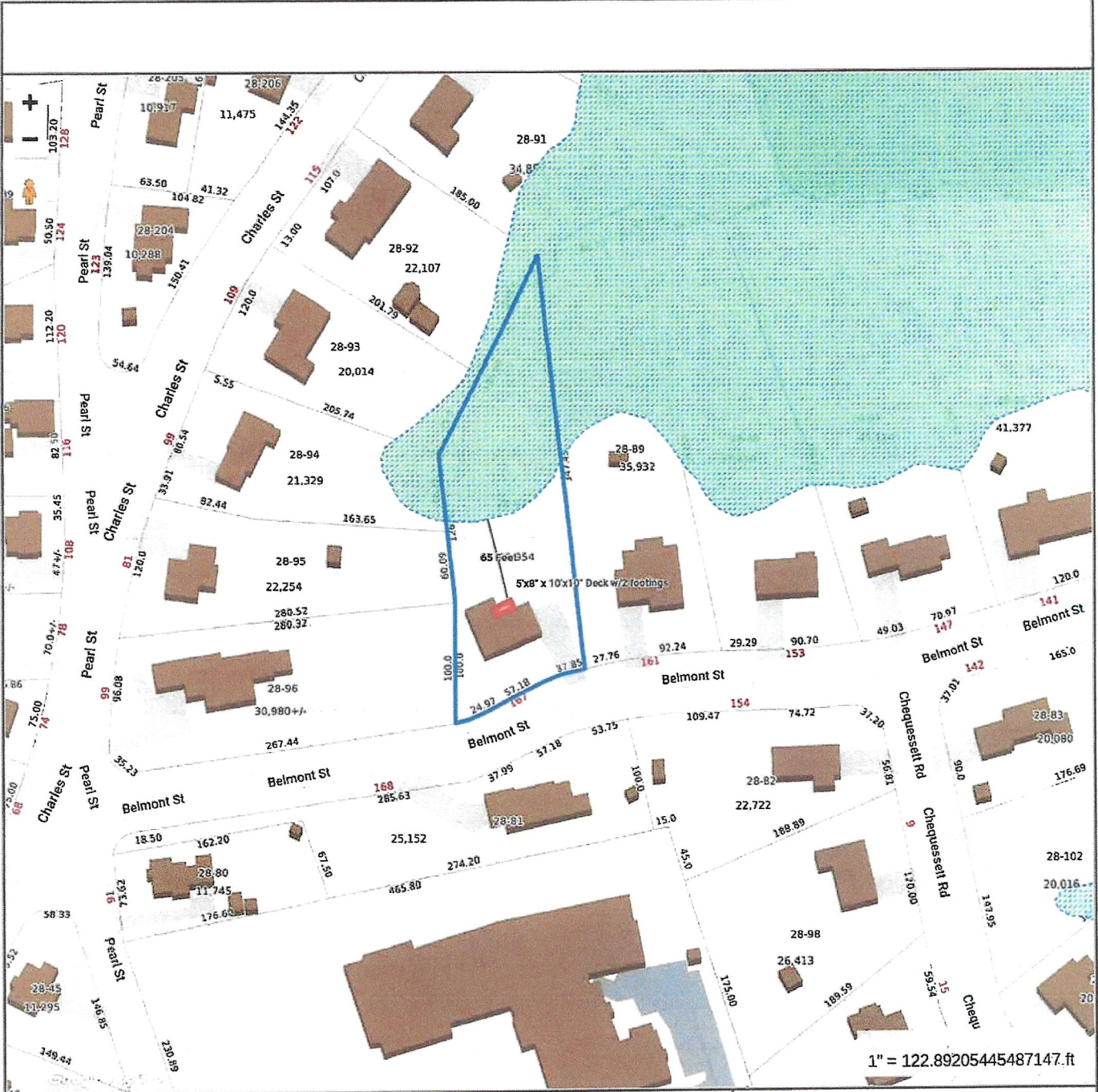

1" = 122.89205445487147.ft

Property Information

Property ID 028.0-0000-0097.0
 Location 167 BELMONT ST
 Owner RYCHLIK BERNARD A JOSEPHINE R RYCHLIK



**MAP FOR REFERENCE ONLY
 NOT A LEGAL DOCUMENT**

Town of Reading, MA makes no claims and no warranties, expressed or implied, concerning the validity or accuracy of the GIS data presented on this map.

Geometry updated 1/1/2020
 Data updated 1/1/2020

Print map scale is approximate. Critical layout or measurement activities should not be done using this resource.