

# FORM B – BUILDING

Assessor's Number    USGS Quad    Area(s)    Form Number

26/193	Reading		398
--------	---------	--	-----

MASSACHUSETTS HISTORICAL COMMISSION  
 MASSACHUSETTS ARCHIVES BUILDING  
 220 MORRISSEY BOULEVARD  
 BOSTON, MASSACHUSETTS 02125

**Town:** Reading

**Place:** (*neighborhood or village*)

## Photograph



**Address:** 351 Lowell Street  
**Historic Name:** Albert C. Robinson House  
**Uses:** Present: residential  
 Original: residential  
**Date of Construction:** 1898  
**Source:** water department records  
**Style/Form:** Shingle Style  
**Architect/Builder:** unknown  
**Exterior Material:**

Foundation:  
 Wall/Trim: wood clapboard/wood shingle  
 Roof: asphalt shingle

## Outbuildings/Secondary Structures:

## Major Alterations (*with dates*):

**Condition:** good  
**Moved:** no | x | yes | | **Date** \_\_\_\_\_  
**Acreage:** 1.17 acres  
**Setting:** mixed residential along busy, main road (Rt. 129)

## Topographic or Assessor's Map

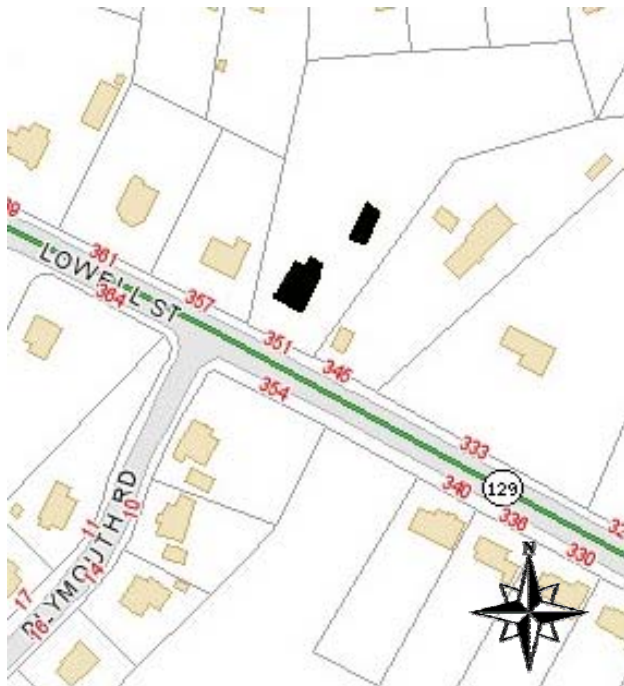

**Recorded by:** Lisa Mausolf  
**Organization:** Reading Historical Commission  
**Date** (*month / year*): December 2009

**RECEIVED**  
**AUG 20 2010**  
**MASS. HIST. COMM.**

# INVENTORY FORM B CONTINUATION SHEET

READING

351 Lowell Street

MASSACHUSETTS HISTORICAL COMMISSION

220 MORRISSEY BOULEVARD, BOSTON, MASSACHUSETTS 02125

Area(s) Form No.

	398
--	-----

Recommended for listing in the National Register of Historic Places.

*If checked, you must attach a completed National Register Criteria Statement form.*

## ARCHITECTURAL DESCRIPTION:

*Describe architectural features. Evaluate the characteristics of this building in terms of other buildings within the community.*

An unusual variation on the Shingle Style, 351 Lowell Street is a 1½-story, wood-shingled cottage capped by a steeply-pitched hip roof which is punctuated on the front by a jerkin-headed recess/balcony and on the east by a jerkin-headed dormer. The house appears to have sustained some degree of alteration but the uniqueness of the design makes it difficult to discern what these are. The façade may well have originally had a recessed porch that was later enclosed. What appear to be later bay windows have been added on the east side.

## HISTORICAL NARRATIVE

*Discuss the history of the building. Explain its associations with local (or state) history. Include uses of the building, and the role(s) the owners/occupants played within the community.*

According to town water records this house (formerly 215 Lowell Street) was constructed for Albert C. Robinson. The water was turned on November 25, 1898. It appears that at various times Robinson or other family members occupied the house, but at other times it was rented out. From about 1909 to 1915 Frank R. Stevens, a conductor, was living here. Charles T. Robinson was living here in 1917 and 1918. Albert Robinson is listed as living here with his family by the time of the 1920 Census. At that time he was then 51 years old and employed as an insurance agent. He was living here with his wife Ivaloo, two sons, daughter and grandson. Robinson was still living here into the early 1930s but in the late 1930s it appears to have been rented.

By 1941 the house was occupied by David and Ethel St. Hilaire. Later owners include Francis St. Hilaire.

## BIBLIOGRAPHY and/or REFERENCES

Middlesex County South Registry of Deeds, Cambridge, Mass.

Reading Directories, various years.

Reading 350<sup>th</sup> Book Committee. *At Wood End – Reading, Massachusetts 1644-1994, A Pictorial History*, 1994.

Town of Reading. List of Persons Twenty Years of Age and Over. Compiled by the Board of Registrars, Reading, Massachusetts, 1907-1979. (No women listed until 1924).

Town of Reading. Valuation of Real and Personal Estates, various dates.

Town of Reading, Water Department Records, 1891-present.

U.S. Census, 1900-1930.