

PREVIOUS VARIANCES AND/OR SPECIAL PERMITS:

THERE ARE NO KNOWN VARIANCES OR SPECIAL PERMITS ISSUED FROM ANY REGULATORY BOARD OR COMMISSION WITHIN THE TOWN OF READING FOR THE SUBJECT SITE.

TEMPORARY BENCHMARK CHART:

TBM #	DESCRIPTION	ELEV.
△	SMH RIM	83.38'

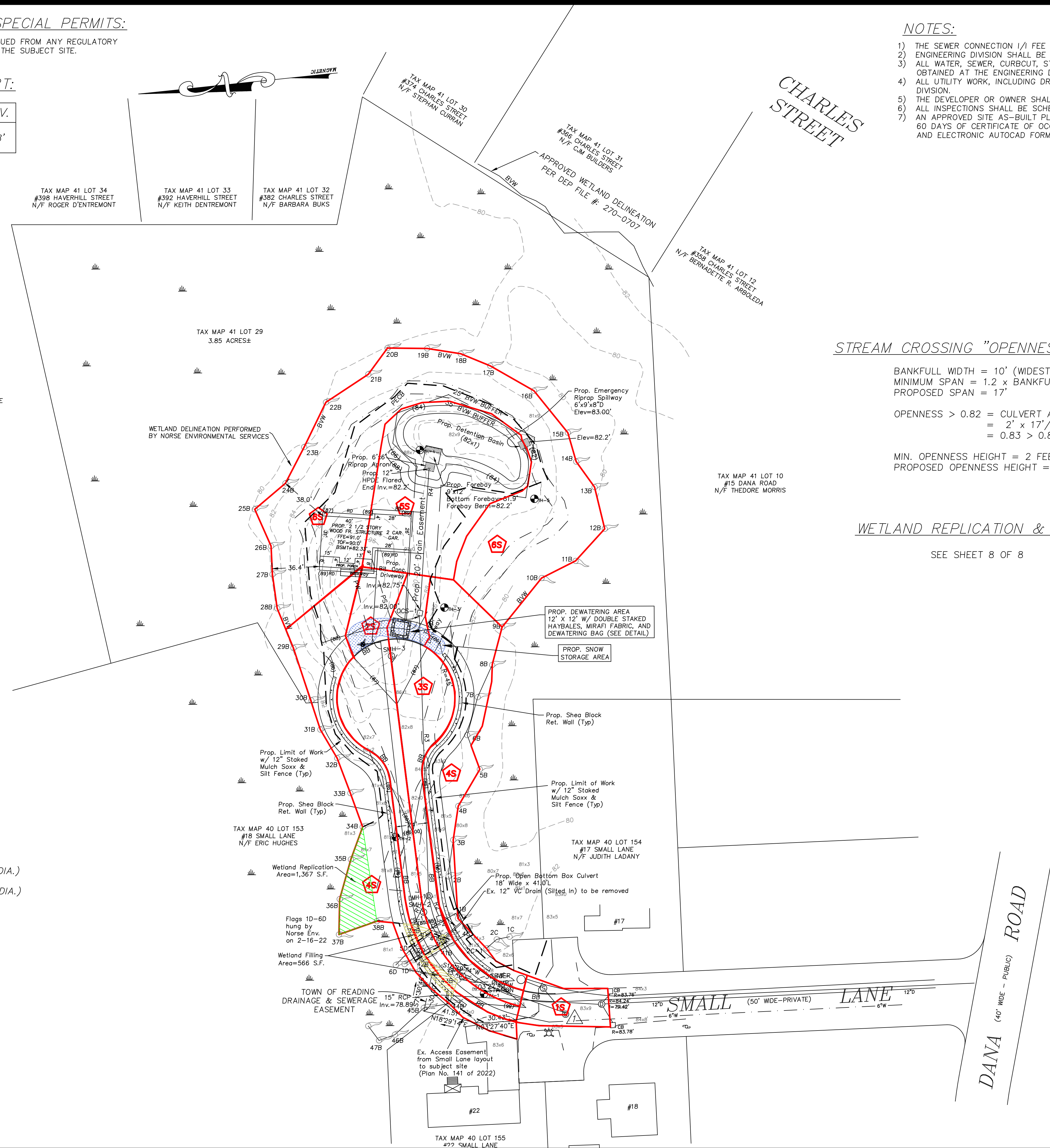

NOTES:

- 1) THE SEWER CONNECTION 1/1 FEE IS REQUIRED FOR THE NEW HOUSE PRIOR TO OCCUPANCY.
- 2) ENGINEERING DIVISION SHALL BE NOTIFIED 72 HOURS IN ADVANCE TO MARK OUT TOWN UTILITIES.
- 3) ALL WATER, SEWER, CURB/CUT, STREET OPENING, & JACKIE'S LAW EXCAVATION PERMITS SHALL BE OBTAINED AT THE ENGINEERING DIVISION PRIOR TO ANY EXCAVATION.
- 4) ALL UTILITY WORK, INCLUDING DRAINAGE INSTALLATION SHALL BE INSPECTED BY THE ENGINEERING DIVISION.
- 5) THE DEVELOPER OR OWNER SHALL SUBMIT A CONSTRUCTION SCHEDULE OF PROPOSED WORK.
- 6) ALL INSPECTIONS SHALL BE SCHEDULED 24 HOURS IN ADVANCE.
- 7) AN APPROVED SITE AS-BUILT PLAN SHALL BE SUBMITTED TO THE ENGINEERING DIVISION WITHIN 60 DAYS OF CERTIFICATE OF OCCUPANCY. THE AS-BUILT SHALL BE PROVIDED ON PAPER COPY AND ELECTRONIC AUTOCAD FORMAT.

FOR REGISTRY OF DEEDS USE ONLY
I DECLARE, TO THE BEST OF MY PROFESSIONAL KNOWLEDGE, INFORMATION, AND BELIEF, THAT THIS PLAN WAS PREPARED IN ACCORDANCE WITH THE RULES AND REGULATIONS OF THE REGISTERS OF DEEDS.

JOHN D. SULLIVAN III, PE DATE

STREAM CROSSING "OPENNESS" CALCULATIONS:

BANKFULL WIDTH = 10' (WIDEST WIDTH)
MINIMUM SPAN = 1.2 x BANKFULL WIDTH = 12'
PROPOSED SPAN = 17'

OPENNESS > 0.82 = CULVERT AREA/PIPE LENGTH
= 2' x 17'/41.0'
= 0.83 > 0.82 (MEETS STANDARD)

MIN. OPENNESS HEIGHT = 2 FEET
PROPOSED OPENNESS HEIGHT = 2' (MEETS STANDARD)

WETLAND REPLICATION & CROSSING

SEE SHEET 8 OF 8

READING COMMUNITY PLANNING & DEVELOPMENT COMMISSION

APPROVED _____, 20__

GRAPHIC SCALE
SCALE: 1"=40'

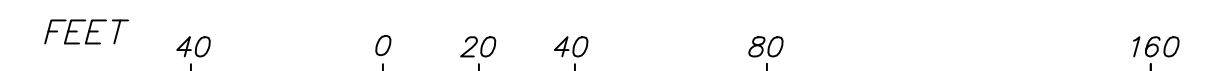

LEGEND:

- 248— TWO FOOT CONTOUR
- DECIDUOUS TREE (> 6" DIA.)
- ⊗ EVERGREEN TREE (> 6" DIA.)
- ⊕ UTILITY POLE
- ⊙ SEWER MANHOLE
- S— SEWER MAIN
- W— COMPILED WATER MAIN
- CB □ CATCHBASIN
- D— DRAIN LINE
- BIT. BITUMINOUS
- CONC. CONCRETE
- EOP EDGE OF PAVEMENT
- TH ⊙ TEST PIT
- (100)— PROP. CONTOUR

SMALL LANE EXTENSION

POSTDEVELOPMENT DRAINAGE PLAN
LOCATED IN
READING, MASSACHUSETTS
(MIDDLESEX COUNTY)

PREPARED FOR
JOSEPH MARINO
SCALE: 1"= 40' DATE: SEPT. 21, 2025

PREPARED BY
SULLIVAN ENGINEERING GROUP, LLC
P.O. BOX 2004
WOBURN, MA 01888
(781) 854-8644

SHEET No. 1 OF 1

