

**LEGEND**

- EXISTING EDGE OF PAVEMENT
- EXISTING GRANITE CURB
- EXISTING GRAVEL DRIVE
- EXISTING CATCH BASIN
- EXISTING DRAIN MANHOLE
- EXISTING DRAIN LINE
- EXISTING SEWER MAIN
- EXISTING SEWER MANHOLE
- PROPOSED SEWER FORCEMAIN
- EXISTING WATER MAIN
- PROPOSED WATER MAIN
- PROPOSED GATE VALVE
- PROPOSED HYDRANT
- PROPOSED CURB STOP
- EXISTING UTILITY POLE
- EXISTING OVERHEAD WIRES
- EDGE OF FLAGGED WETLAND
- EDGE OF ESTIMATED WETLAND
- WETLAND FLAG
- 35' NO BUILD ZONE
- 25' NO DISTURB ZONE
- 100-YEAR FLOOD PLAIN

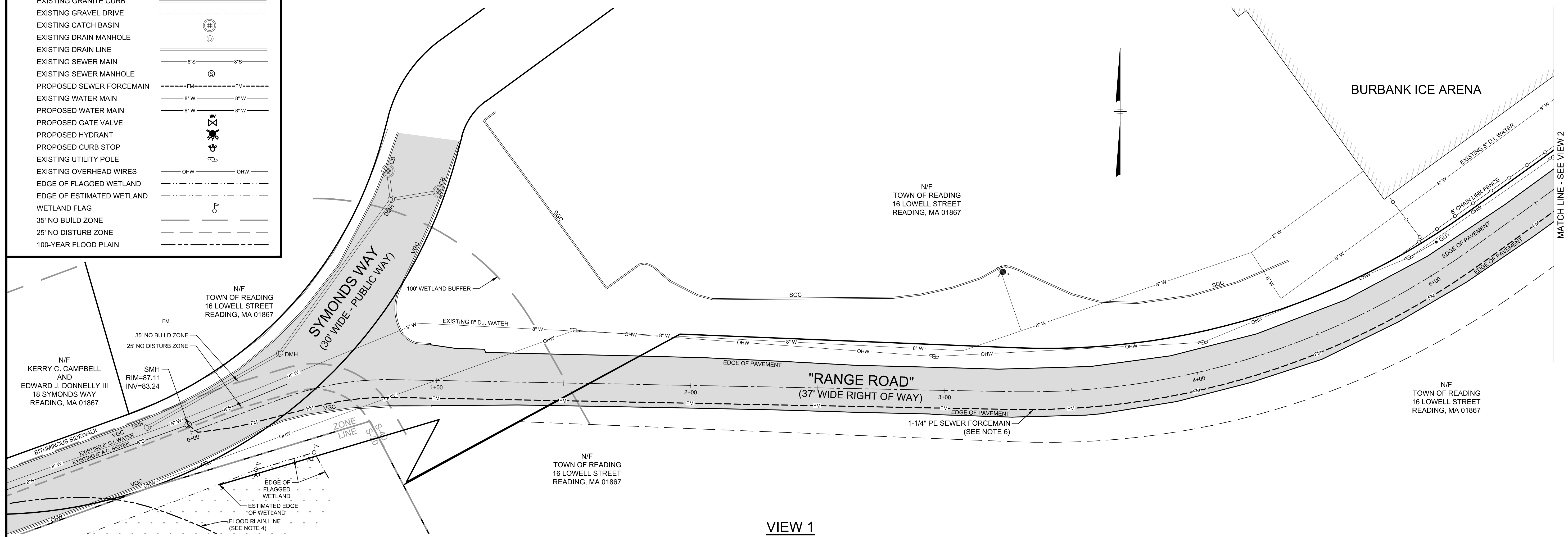

**VIEW 1**

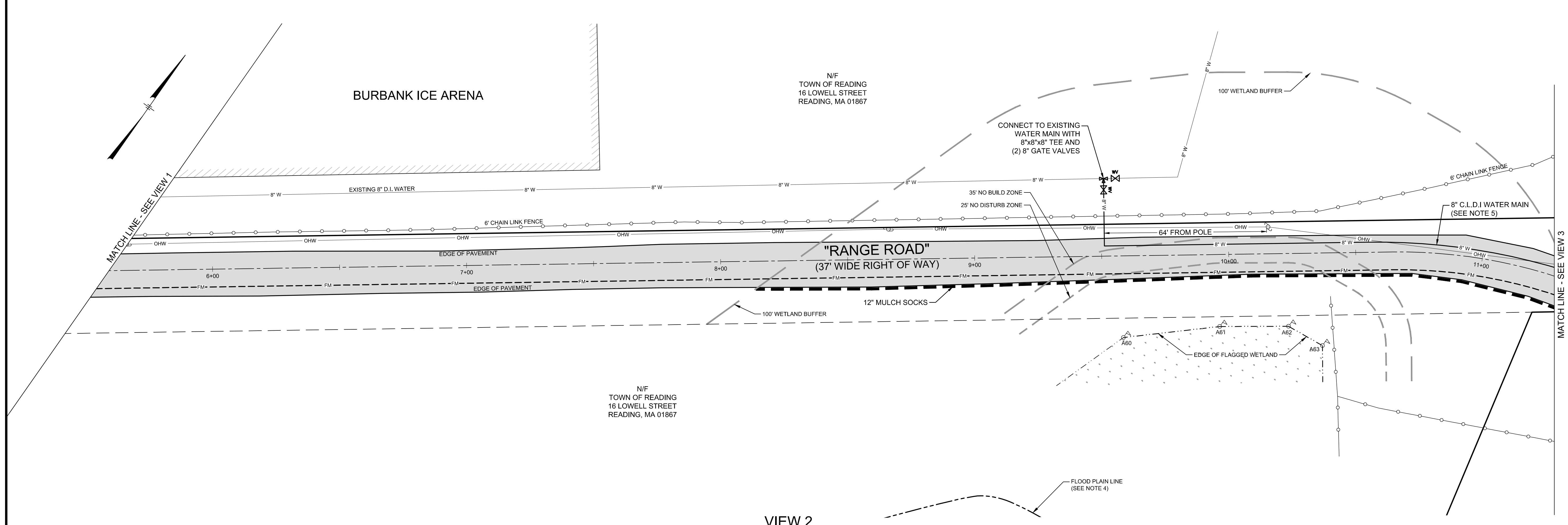

**VIEW 2**

**GENERAL NOTES**

1. TOPOGRAPHIC INFORMATION IS THE RESULT OF A FIELD SURVEY. ELEVATIONS ARE BASED ON NAVD 1988.
2. WETLAND FLAGS ON THE SUBJECT PROPERTY WERE ESTABLISHED BY L.E.C. ENVIRONMENTAL CONSULTANTS, INC. ON NOVEMBER 12 AND 13, 2013 AND FIELD LOCATED BY ALAN ENGINEERING, L.L.C.
3. THE "A" SERIES WETLAND FLAGS ARE FROM AN UNKNOWN SOURCE AND WERE FIELD LOCATED BY ALAN ENGINEERING, L.L.C. IN MAY 2023.
4. FLOOD PLAIN LINE WAS TAKEN FROM FEMA FLOOD INSURANCE RATE MAP 25017C0312E, EFFECTIVE DATE JUNE 4, 2010.
5. WATER MAIN SECTIONS MAY HAVE A MAXIMUM DEFLECTION ANGLE OF 5° WHICH WILL EQUATE TO A RADIUS OF CURVATURE OF APPROXIMATELY 195' FOR 18" SECTIONS AND 220' FOR 20" SECTIONS. ALL PIPING SHALL BE PRESSURE TESTED TO ASSURE WATER-TIGHTNESS.
6. SEWER LINES SHALL BE INSTALLED A MINIMUM OF 10 FEET FROM WATER SUPPLY LINES. WHERE THIS CAN NOT BE MET OR WHERE THEY CROSS, THE SEWER SHALL BE 18 INCHES BELOW THE WATER MAIN AND BOTH PIPES SHALL BE CONSTRUCTED OF CLASS 150 PRESSURE PIPE.
7. EXACT LOCATION AND ELEVATION OF THE EXISTING SEWER LINE OUT OF THE BUILDING AND THE SEPTIC TANK ARE TO BE DETERMINED IN THE FIELD PRIOR TO INSTALLING THE ENVIRONMENT ONE LIFT STATION. THE DESIGN ENGINEER IS TO BE NOTIFIED OF ANY DISCREPANCIES THAT WOULD REQUIRE DESIGN CHANGES.
8. SEWER AND WATER TO HAVE A MINIMUM OF 4 FEET OF COVER.

**DEED REFERENCES:**  
 M.S.R.D. BOOK 5915, PAGE 430  
 M.S.R.D. BOOK 8345, PAGE 407  
 M.S.R.D. BOOK 8897, PAGE 215  
 M.S.R.D. BOOK 9447, PAGE 490  
 M.S.R.D. BOOK 12039, PAGE 143

**RECORD OWNER:**  
 READING RIFLE & REVOLVER CLUB  
 P.O. BOX 212  
 READING, MA 01867

**ASSESSORS PARCEL IDS:**  
 035.0-0000-0134.0  
 041.0-0000-0055.0  
 041.0-0000-0058.0  
 042.0-0000-0001.0  
 042.0-0000-0004.0

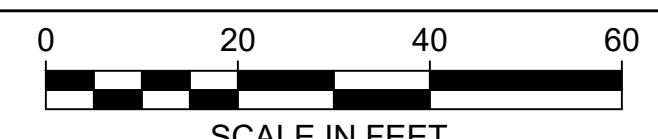

MAS	ADD MULCH SOCKS	10/17/2023
BY	REVISIONS	DATE

**WATER AND SEWER CONNECTION PLAN**  
 READING RIFLE & REVOLVER CLUB  
 READING, MA 01867

**ALAN ENGINEERING, L.L.C.**  
 110 WINN STREET, SUITE 209  
 WOBURN, MA 01801  
 (781) 287-9789  
 alan.eng@verizon.net

**PREPARED FOR:**  
 READING RIFLE & REVOLVER CLUB  
 P.O. BOX 212  
 READING, MA 01867

JOB NO: 1104	DWG NO: 2115
JUNE 26, 2023	<b>1 of 3</b>
SCALE: 1" = 20'	

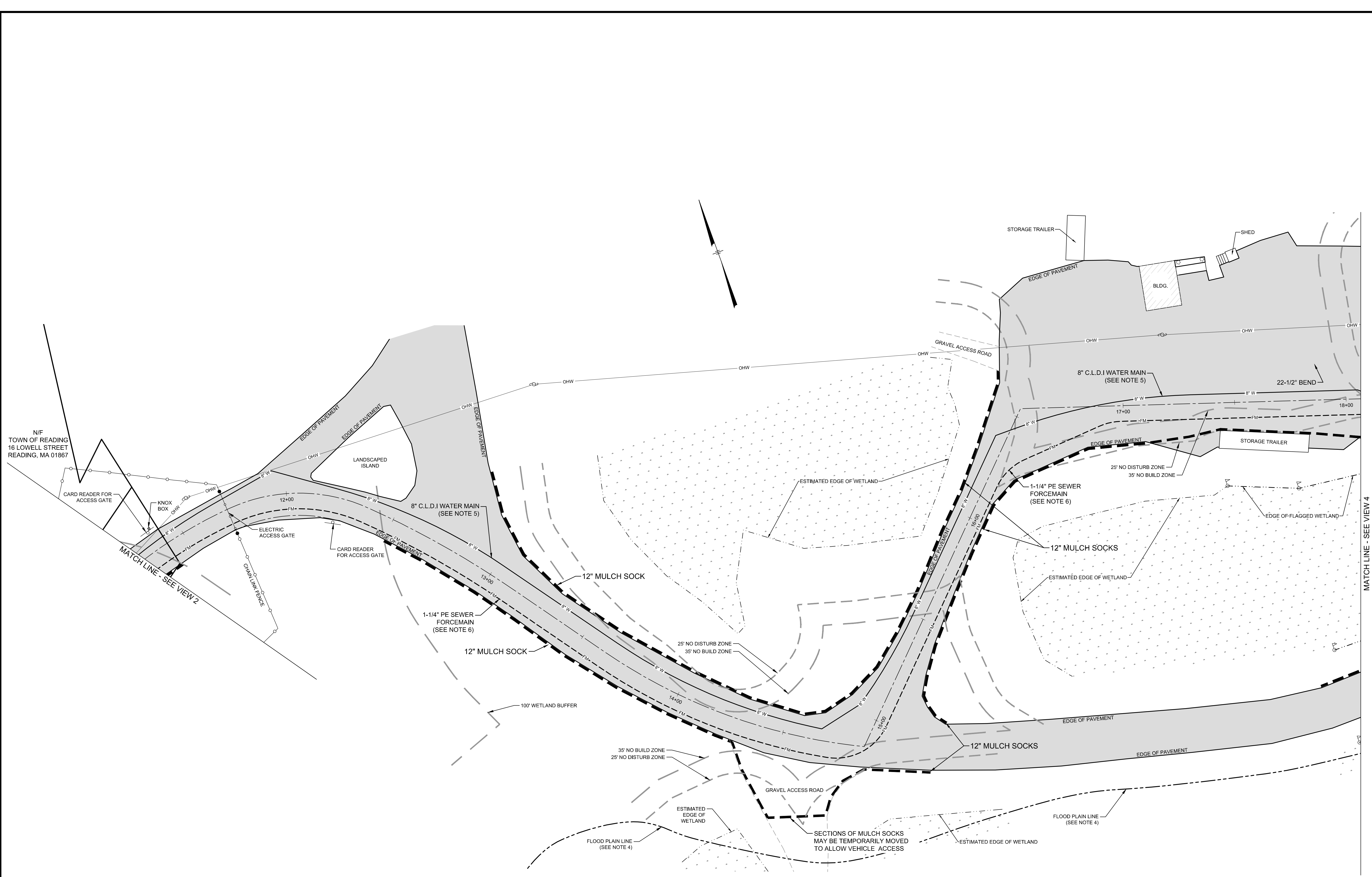

VIEW 3

**GENERAL NOTES**

1. TOPOGRAPHIC INFORMATION IS THE RESULT OF A FIELD SURVEY. ELEVATIONS ARE BASED ON NAVD 1988.
2. WETLAND FLAGS ON THE SUBJECT PROPERTY WERE ESTABLISHED BY L.E.C. ENVIRONMENTAL CONSULTANTS, INC. ON NOVEMBER 12 AND 13, 2013 AND FIELD LOCATED BY ALAN ENGINEERING, L.L.C.
3. THE "A" SERIES WETLAND FLAGS ARE FROM AN UNKNOWN SOURCE AND WERE FIELD LOCATED BY ALAN ENGINEERING, L.L.C. IN MAY 2023.
4. FLOOD PLAIN LINE WAS TAKEN FROM FEMA FLOOD INSURANCE RATE MAP 25017C0312E, EFFECTIVE DATE JUNE 4, 2010.
5. WATER MAIN SECTIONS MAY HAVE A MAXIMUM DEFLECTION ANGLE OF 5° WHICH WILL EQUATE TO A RADIUS OF CURVATURE OF APPROXIMATELY 195' FOR 18' SECTIONS AND 220' FOR 20' SECTIONS. ALL PIPING SHALL BE PRESSURE TESTED TO ASSURE WATER-TIGHTNESS.
6. SEWER LINES SHALL BE INSTALLED A MINIMUM OF 10 FEET FROM WATER SUPPLY LINES. WHERE THIS CAN NOT BE MET OR WHERE THEY CROSS, THE SEWER SHALL BE 18 INCHES BELOW THE WATER MAIN AND BOTH PIPES SHALL BE CONSTRUCTED OF CLASS 150 PRESSURE PIPE.
7. EXACT LOCATION AND ELEVATION OF THE EXISTING SEWER LINE OUT OF THE BUILDING AND THE SEPTIC TANK ARE TO BE DETERMINED IN THE FIELD PRIOR TO INSTALLING THE ENVIRONMENT ONE LIFT STATION. THE DESIGN ENGINEER IS TO BE NOTIFIED OF ANY DISCREPANCIES THAT WOULD REQUIRE DESIGN CHANGES.
8. SEWER AND WATER TO HAVE A MINIMUM OF 4 FEET OF COVER.

**DEED REFERENCES:**  
 M.S.R.D. BOOK 5915, PAGE 430  
 M.S.R.D. BOOK 8345, PAGE 407  
 M.S.R.D. BOOK 8897, PAGE 215  
 M.S.R.D. BOOK 9447, PAGE 490  
 M.S.R.D. BOOK 12039, PAGE 143

**RECORD OWNER:**  
 READING RIFLE & REVOLVER CLUB  
 P.O. BOX 212  
 READING, MA 01867

**ASSESSORS PARCEL IDS:**  
 035.0-0000-0134.0  
 041.0-0000-0055.0  
 041.0-0000-0058.0  
 042.0-0000-0001.0  
 042.0-0000-0004.0

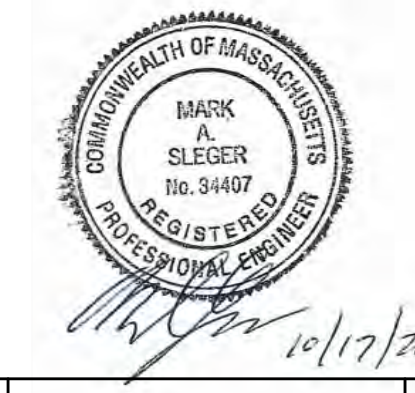
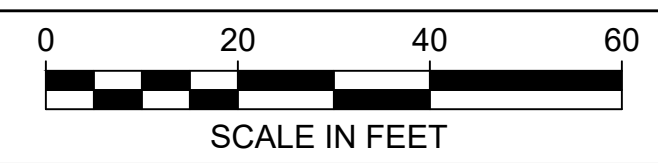

MAS	ADD MULCH SOCKS	10/17/2023
BY	REVISIONS	DATE

**WATER AND SEWER CONNECTION PLAN**  
**READING RIFLE & REVOLVER CLUB**  
**READING, MA 01867**

**ALAN ENGINEERING, L.L.C.**  
 110 WINN STREET, SUITE 209  
 WOBURN, MA 01801  
 (781) 287-9789  
 alan.eng@verizon.net

**PREPARED FOR:**  
 READING RIFLE & REVOLVER CLUB  
 P.O. BOX 212  
 READING, MA 01867

JOB NO: 1104	DWG NO: 2115
JUNE 26, 2023	<b>2 of 3</b>
SCALE: 1" = 20'	

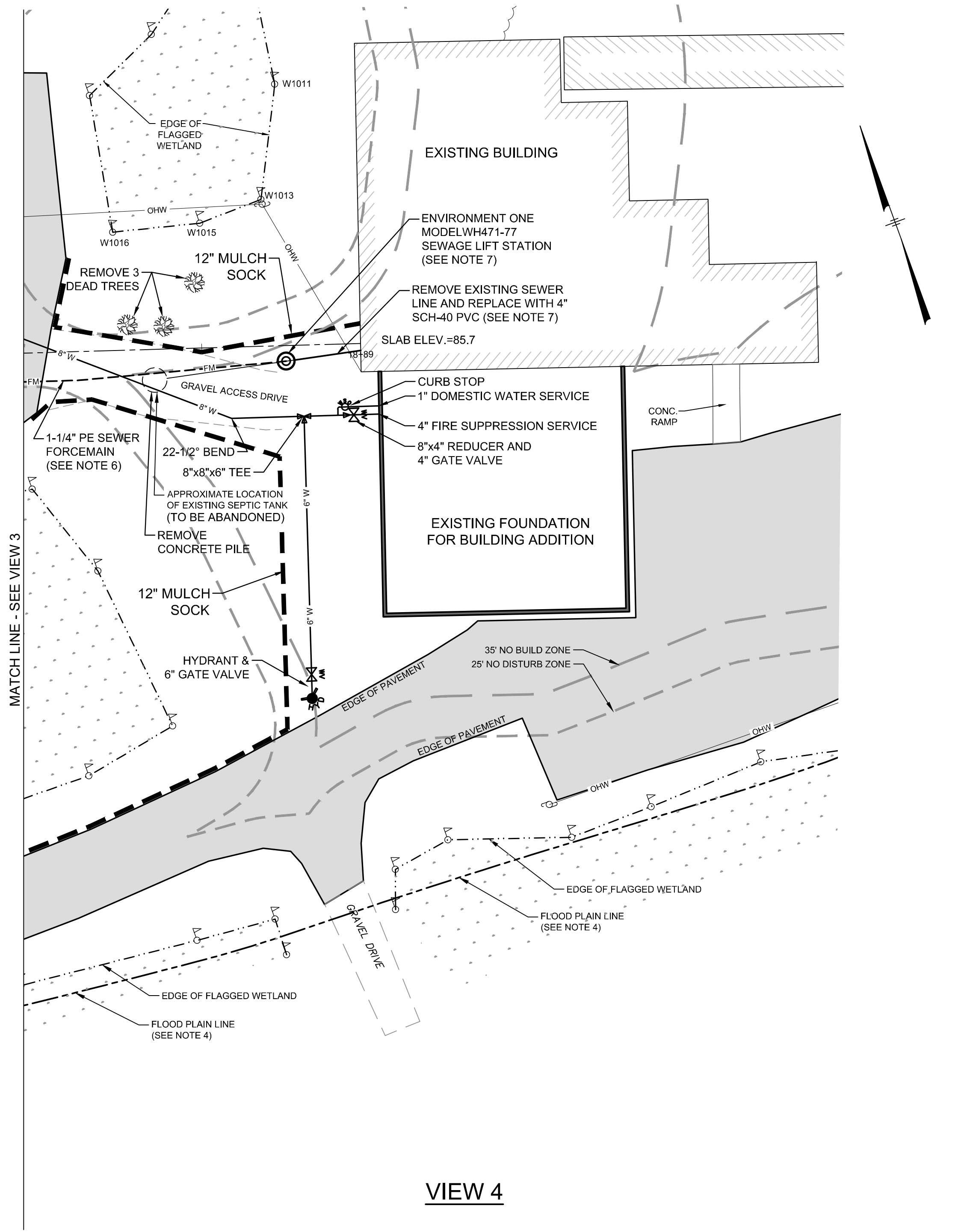

VIEW 4

**SEWER FLOW CALCULATIONS & PUMP STATION SELECTION**  
 SEWER FLOW CALCULATIONS ARE BASED ON 310 CMR 15.203 (TITLE 5)  
 CURRENT & PROPOSED USE: SHOOTING RANGE AND CLUB HOUSE WITH SNACK ROOM  
 INDOOR SHOOTING STATIONS: 24  
 OUTDOOR SHOOTING STATIONS: 30 (ADJACENT TO CLUB HOUSE)  
 MEETING ROOM SEATING: 60  
 TOTAL CAPACITY: 114  
 SIMILAR TITLE 5 USE: COUNTRY CLUB WITH SNACK BAR OR LUNCH ROOM  
 DESIGN FLOW: 10 GPD PER PERSON  
 TOTAL DESIGN FLOW: 10 GPD / PERSON x 114 PERSONS = 1,140 GPD  
 USE: ENVIRONMENT ONE WH471-77  
 DAILY FLOW CAPACITY: 2,000 GPD  
 STORAGE CAPACITY: 476 GALLONS

**PUMP STATION BUOYANCY CALCULATIONS**  
 ESTIMATED SEASONAL HIGH GROUNDWATER ELEVATION: 81.5  
 BOTTOM OF LIFT STATION ELEVATION: 78.7  
 VOLUME OF SUBMERGED LIFT STATION: 14.2 S.F. x (81.5-78.7) = 40 CU-FT  
 UPLIFT FORCE: 40 CU-FT x 62.4 LBS/CU-FT = 2,496 LBS  
 STATION WEIGHT (DRY): 340 LBS  
 BALLAST REQUIRED: 2,496 LBS - 340 LBS = 2,156 LBS

USE POURED CONCRETE BALLAST: 150 LBS / CU-FT  
 BALLAST REQUIRED: 2,156 LBS / (150 LBS / CU-FT) = 14.4 CU-FT  
 BALLAST PROPOSED: 21.1 CU-FT x (150 LBS / CU-FT) = 3,165 LBS

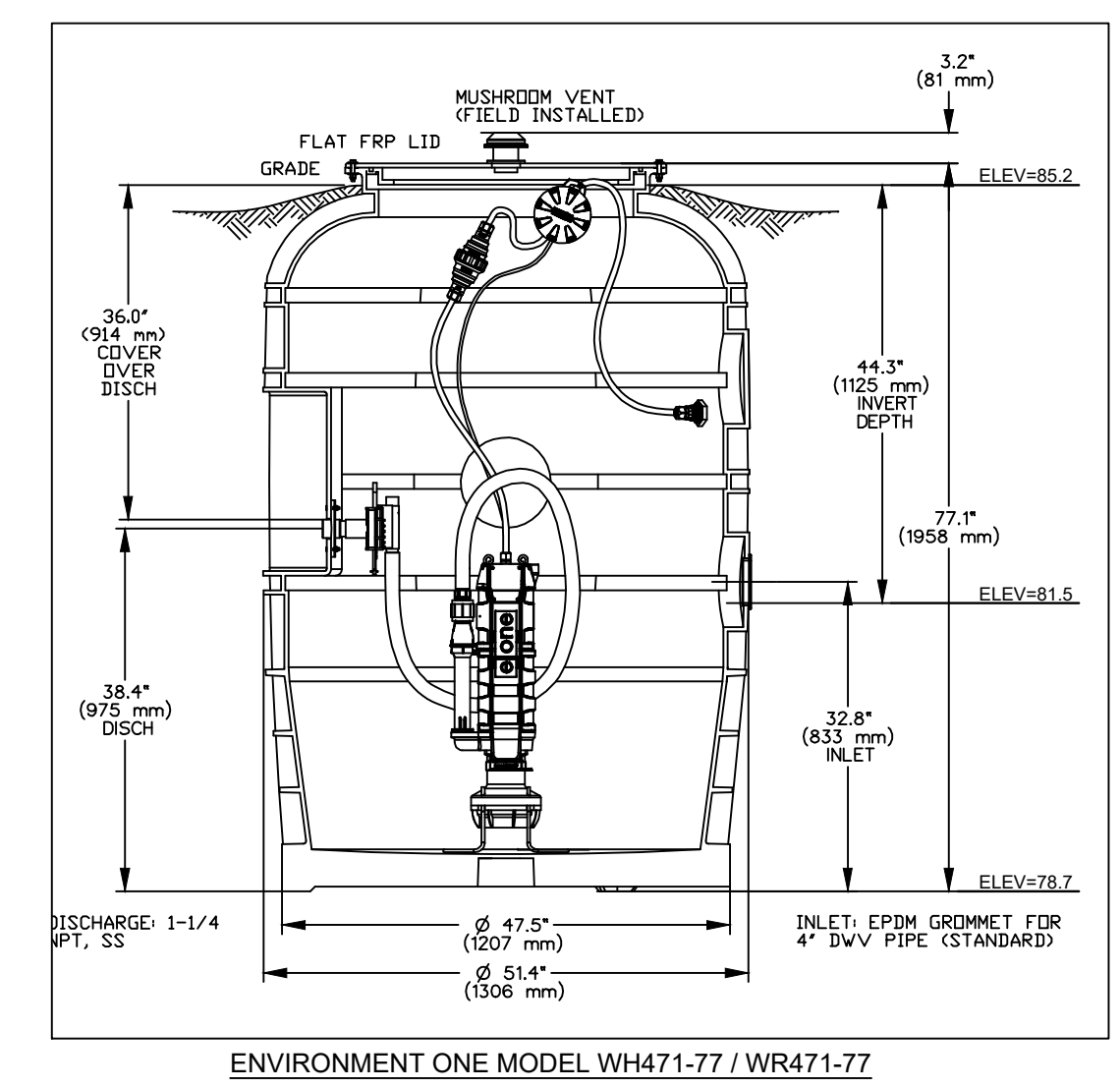

ENVIRONMENT ONE MODEL WH471-77 / WR471-77  
 ENVIRONMENT ONE LIFT STATION  
 NOT TO SCALE

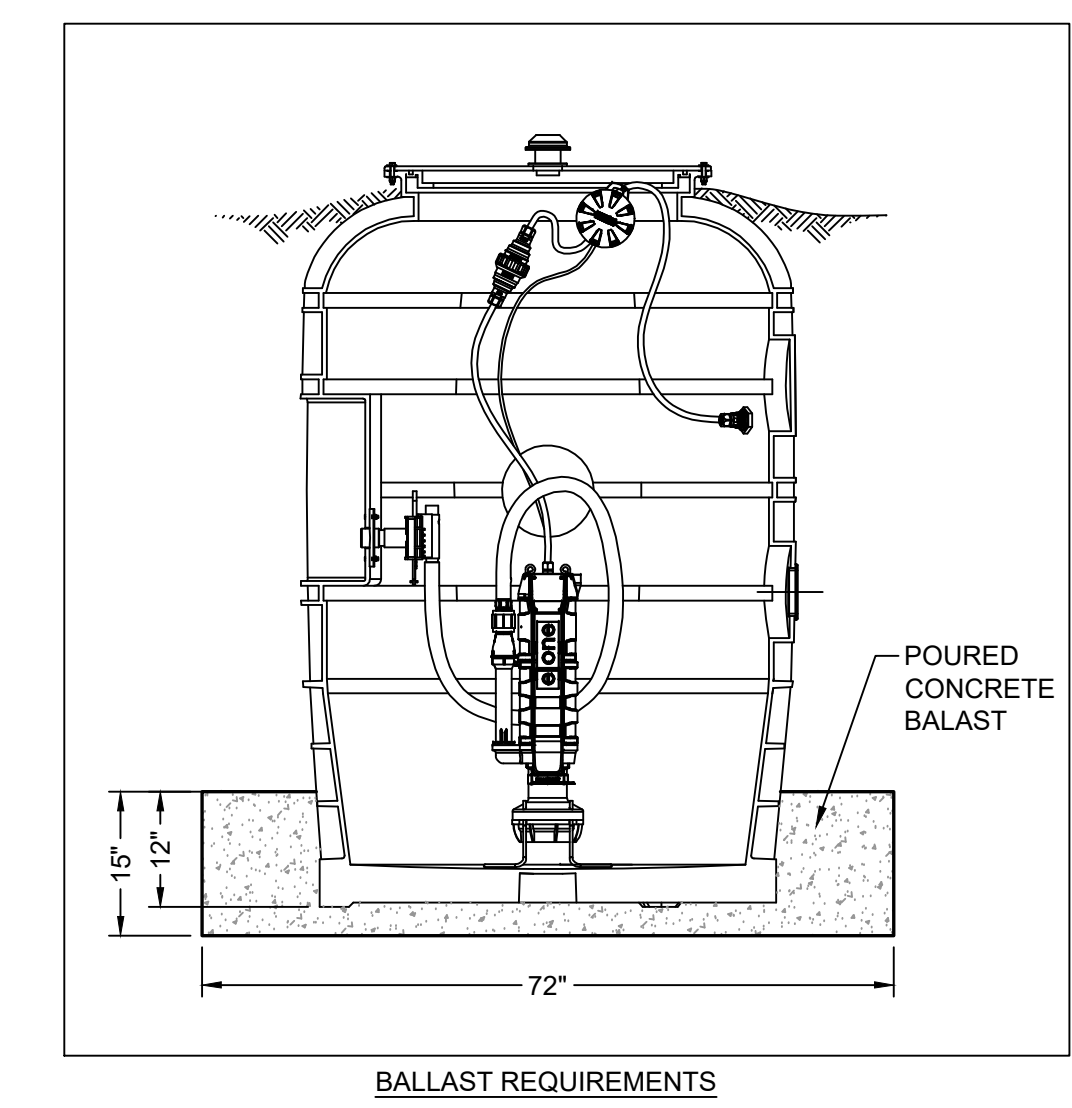

BALLAST REQUIREMENTS

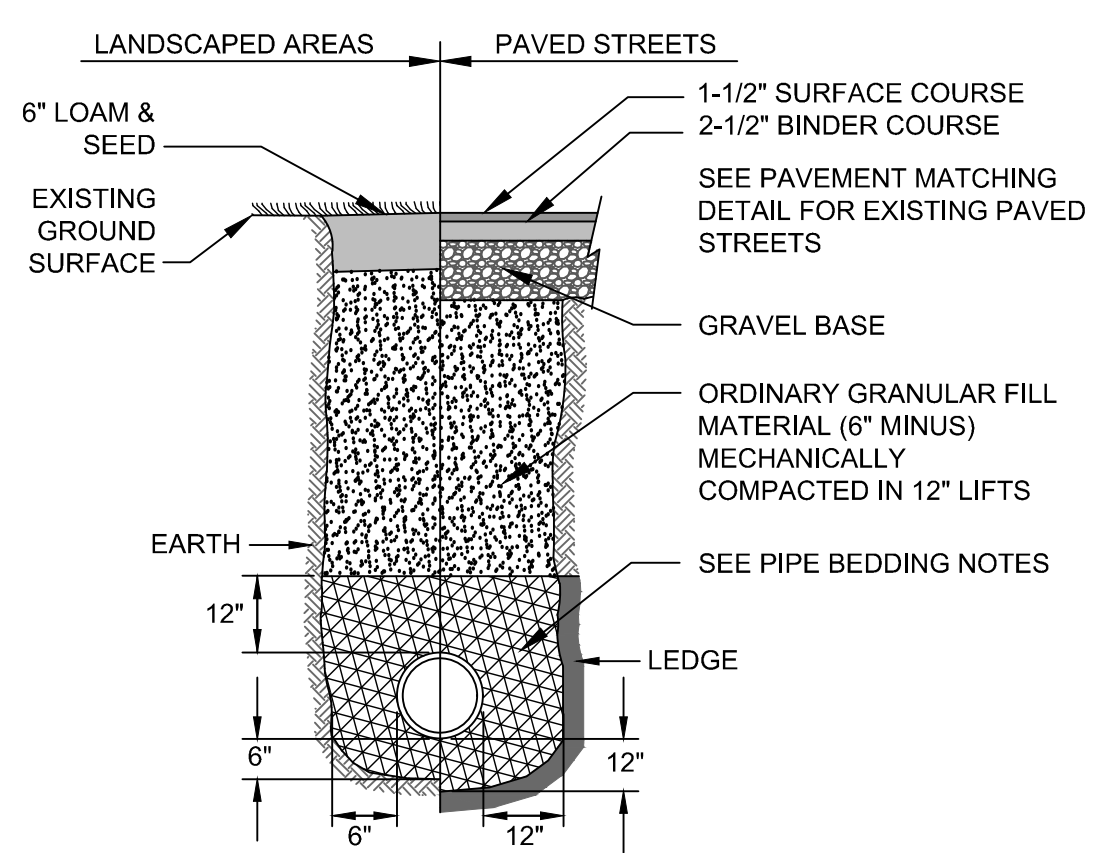

TYPICAL TRENCH SECTION  
 NOT TO SCALE

PIPE BEDDING NOTES:  
 FOR CLDI WATER MAINS USE SAND  
 FOR PVC, PE AND HDPE PIPING USE 3/4\"/>

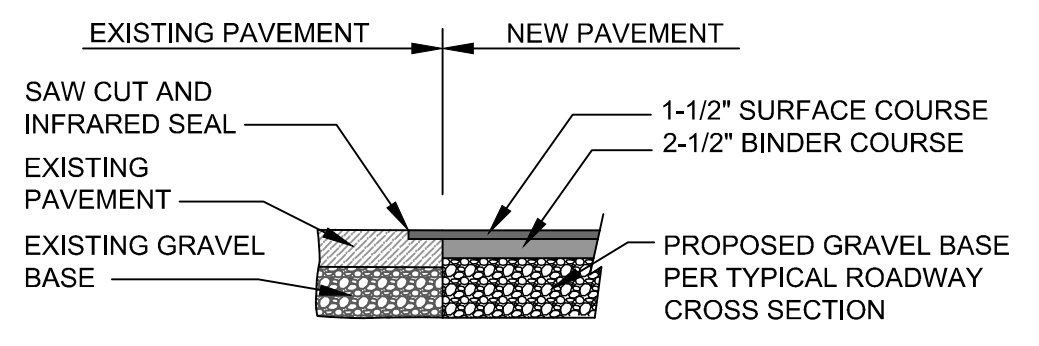

PAVEMENT MATCHING DETAIL  
 NOT TO SCALE

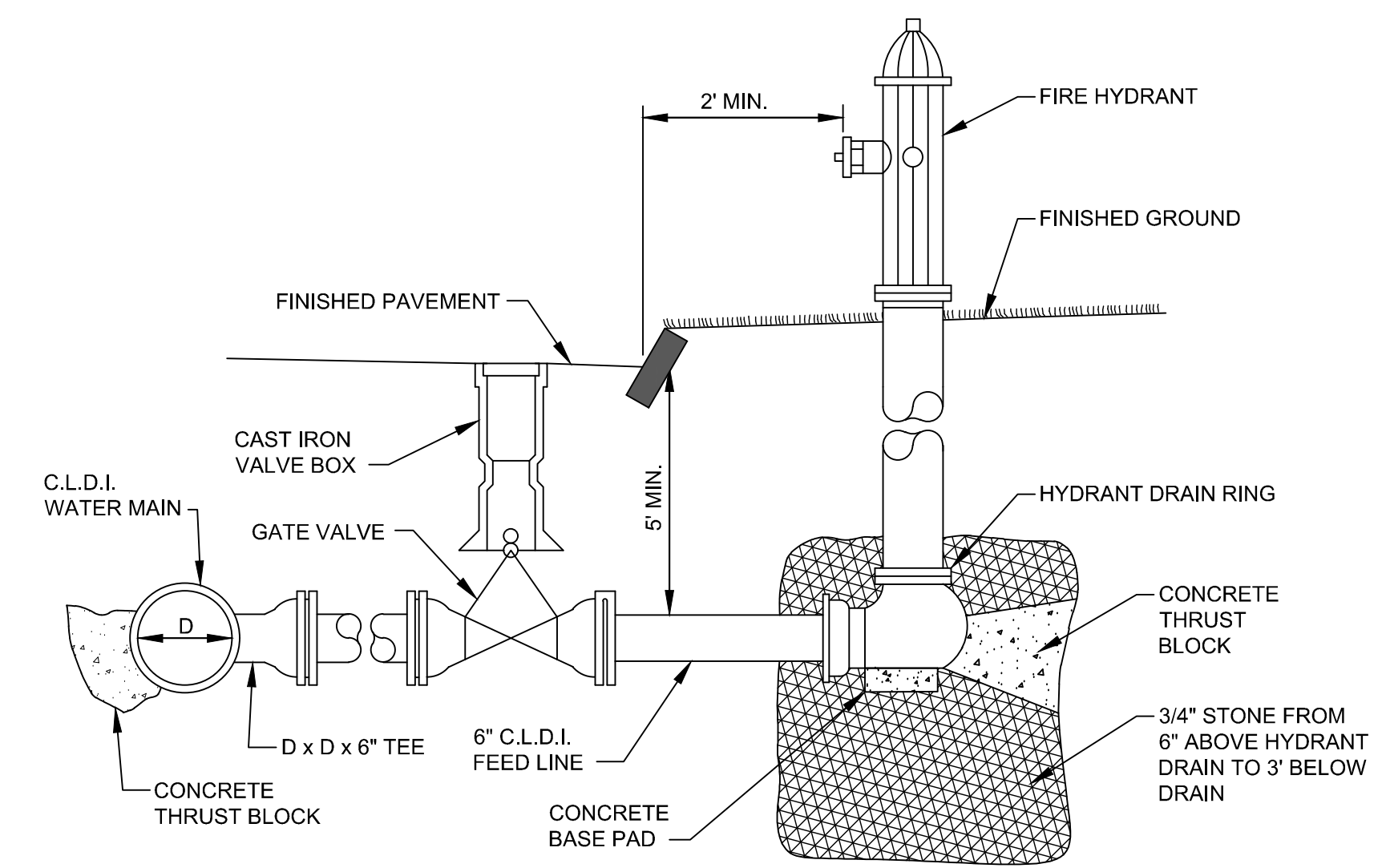

HYDRANT CONNECTION DETAIL  
 NOT TO SCALE

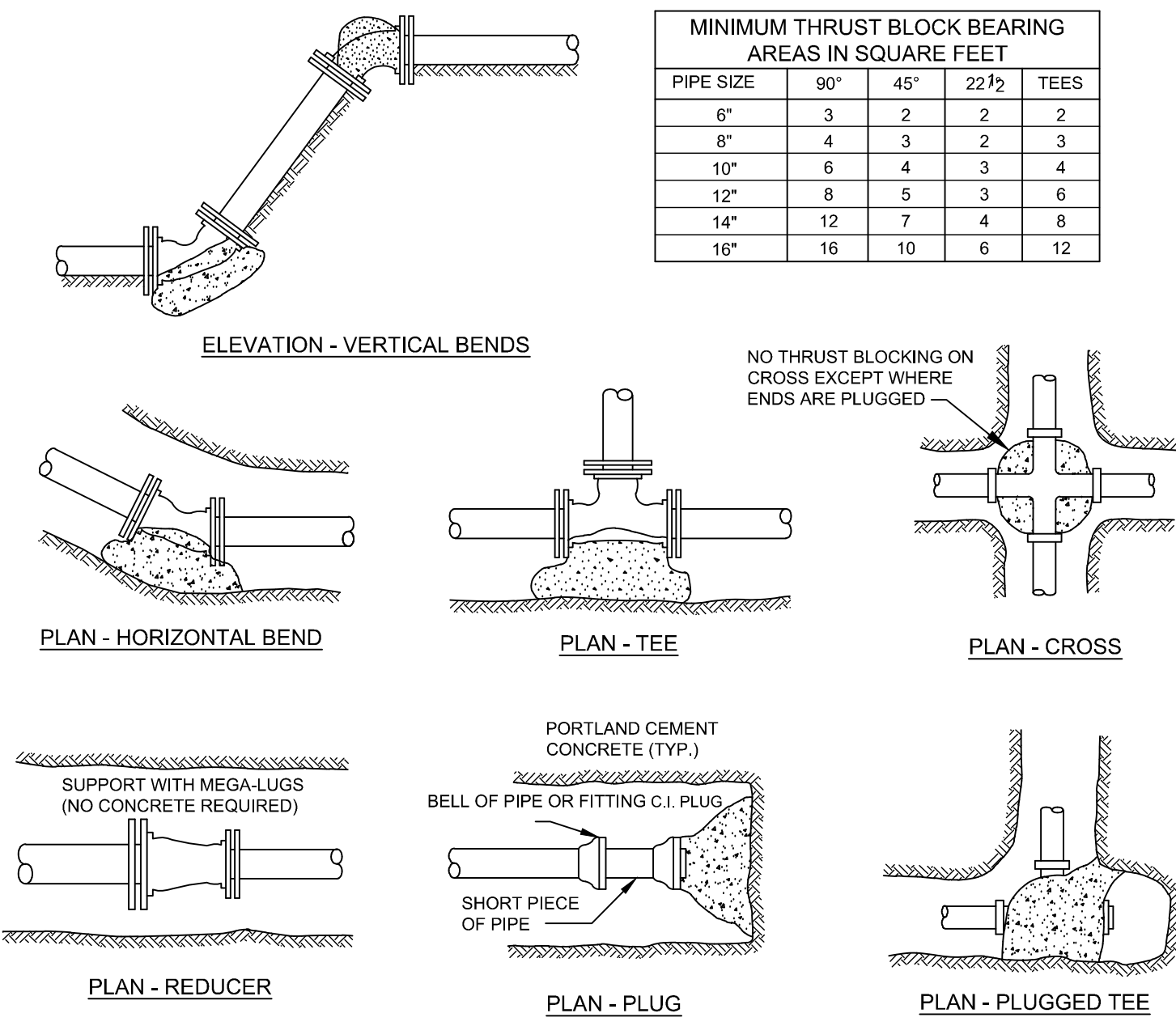

WATER MAIN DETAILS  
 NOT TO SCALE

- NOTES:
- ALL CONSTRUCTION METHODS AND MATERIALS SHALL CONFORM TO THE SPECIFICATIONS OF THE LOCAL WATER DEPARTMENT.
  - CONCRETE SHALL BE 3,000 PSI MINIMUM AT 28 DAYS.
  - THRUST BLOCKS SHALL BE PLACED AGAINST UNDISTURBED EARTH.
  - ALL FITTINGS (EXCEPT AS INDICATED) SHALL BE SUPPORTED AND ANCHORED IN CONCRETE AND WITH "MEGALUG JOINT RESTRAINTS" OR APPROVED EQUAL.
  - FOR FIRE HYDRANT THRUSTING SEE HYDRANT CONNECTION DETAIL.
  - POURED CONCRETE SHALL BE KEPT 6" CLEAR OF MECHANICAL JOINTS TO ALLOW FOR FUTURE REPAIR OR REMOVAL.
  - RETAINER GLANDS REQUIRED ON ALL BENDS.
  - ALL MECHANICAL JOINT GLANDS SHALL BE WEDGE-ACTION LOCKING RESTRAINT TYPE.
  - BELL ENDS OF PUSH-ON PIPE WITHIN 30 FEET OF THE TERMINATION OF THE WATER MAIN OR EITHER SIDE OF A 90-DEGREE BEND SHALL BE MECHANICALLY RESTRAINED. (FIELD-LOC GASKETS, RODS AND RESTRAINT CLAMPS OF SET SCREW PLUG)
  - BRONZE CONDUCTIVITY WEDGES (2) SHALL BE INSTALLED AT EACH BELL JOINT.
  - THE TAPPING SLEEVE SHALL BE ALL STAINLESS STEEL WRAP-AROUND TYPE.

GENERAL NOTES

- TOPOGRAPHIC INFORMATION IS THE RESULT OF A FIELD SURVEY. ELEVATIONS ARE BASED ON NAVD 1988.
- WETLAND FLAGS ON THE SUBJECT PROPERTY WERE ESTABLISHED BY L.E.C. ENVIRONMENTAL CONSULTANTS, INC. ON NOVEMBER 12 AND 13, 2013 AND FIELD LOCATED BY ALAN ENGINEERING, L.L.C.
- THE "A" SERIES WETLAND FLAGS ARE FROM AN UNKNOWN SOURCE AND WERE FIELD LOCATED BY ALAN ENGINEERING, L.L.C. IN MAY 2023.
- FLOOD PLAIN LINE WAS TAKEN FROM FEMA FLOOD INSURANCE RATE MAP 25017C0312E, EFFECTIVE DATE JUNE 4, 2010.
- WATER MAIN SECTIONS MAY HAVE A MAXIMUM DEFLECTION ANGLE OF 5" WHICH WILL EQUATE TO A RADIUS OF CURVATURE OF APPROXIMATELY 195' FOR 18' SECTIONS AND 220' FOR 20' SECTIONS. ALL PIPING SHALL BE PRESSURE TESTED TO ASSURE WATER-TIGHTNESS.
- SEWER LINES SHALL BE INSTALLED A MINIMUM OF 10 FEET FROM WATER SUPPLY LINES. WHERE THIS CAN NOT BE MET OR WHERE THEY CROSS, THE SEWER SHALL BE 18 INCHES BELOW THE WATER MAIN AND BOTH PIPES SHALL BE CONSTRUCTED OF CLASS 150 PRESSURE PIPE.
- EXACT LOCATION AND ELEVATION OF THE EXISTING SEWER LINE OUT OF THE BUILDING AND THE SEPTIC TANK ARE TO BE DETERMINED IN THE FIELD PRIOR TO INSTALLING THE ENVIRONMENT ONE LIFT STATION. THE DESIGN ENGINEER IS TO BE NOTIFIED OF ANY DISCREPANCIES THAT WOULD REQUIRE DESIGN CHANGES.
- SEWER AND WATER TO HAVE A MINIMUM OF 4 FEET OF COVER.

DEED REFERENCES:  
 M.S.R.D. BOOK 5915, PAGE 430  
 M.S.R.D. BOOK 8345, PAGE 407  
 M.S.R.D. BOOK 8897, PAGE 215  
 M.S.R.D. BOOK 9447, PAGE 490  
 M.S.R.D. BOOK 12039, PAGE 143

RECORD OWNER:  
 READING RIFLE & REVOLVER CLUB  
 P.O. BOX 212  
 READING, MA 01867

ASSESSORS PARCEL IDS:  
 035.0-0000-0134.0  
 041.0-0000-0055.0  
 041.0-0000-0058.0  
 042.0-0000-0001.0  
 042.0-0000-0004.0

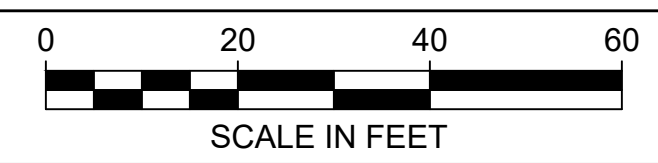

SCALE IN FEET



MAS	ADD MULCH SOCKS	10/17/2023
BY	REVISIONS	DATE

WATER AND SEWER CONNECTION PLAN  
 READING RIFLE & REVOLVER CLUB  
 READING, MA 01867

ALAN ENGINEERING, L.L.C.  
 110 WINN STREET, SUITE 209  
 WOBURN, MA 01801  
 (781) 287-9789  
 alan.eng@verizon.net

PREPARED FOR:  
 READING RIFLE & REVOLVER CLUB  
 P.O. BOX 212  
 READING, MA 01867

JOB NO: 1104	DWG NO: 2115
JUNE 26, 2023	3 of 3
SCALE: 1" = 20'	